

DPC/AIR SEAL KEY

- EDPM (EXTERNAL)
- pU FOAM INSULATION
- EXTERNAL WEATHER SEAL
- SEALANT
- INTERNAL - FLEXIBLE MEMBRANE BY INSTALLER FOR AIR SEALING
- AIR SEAL TAPE
- BREATHER MEMBRANE
- VAPOUR CONTROL LAYER
- DPC
- ATAL PREMSIL
- INSECT MESH

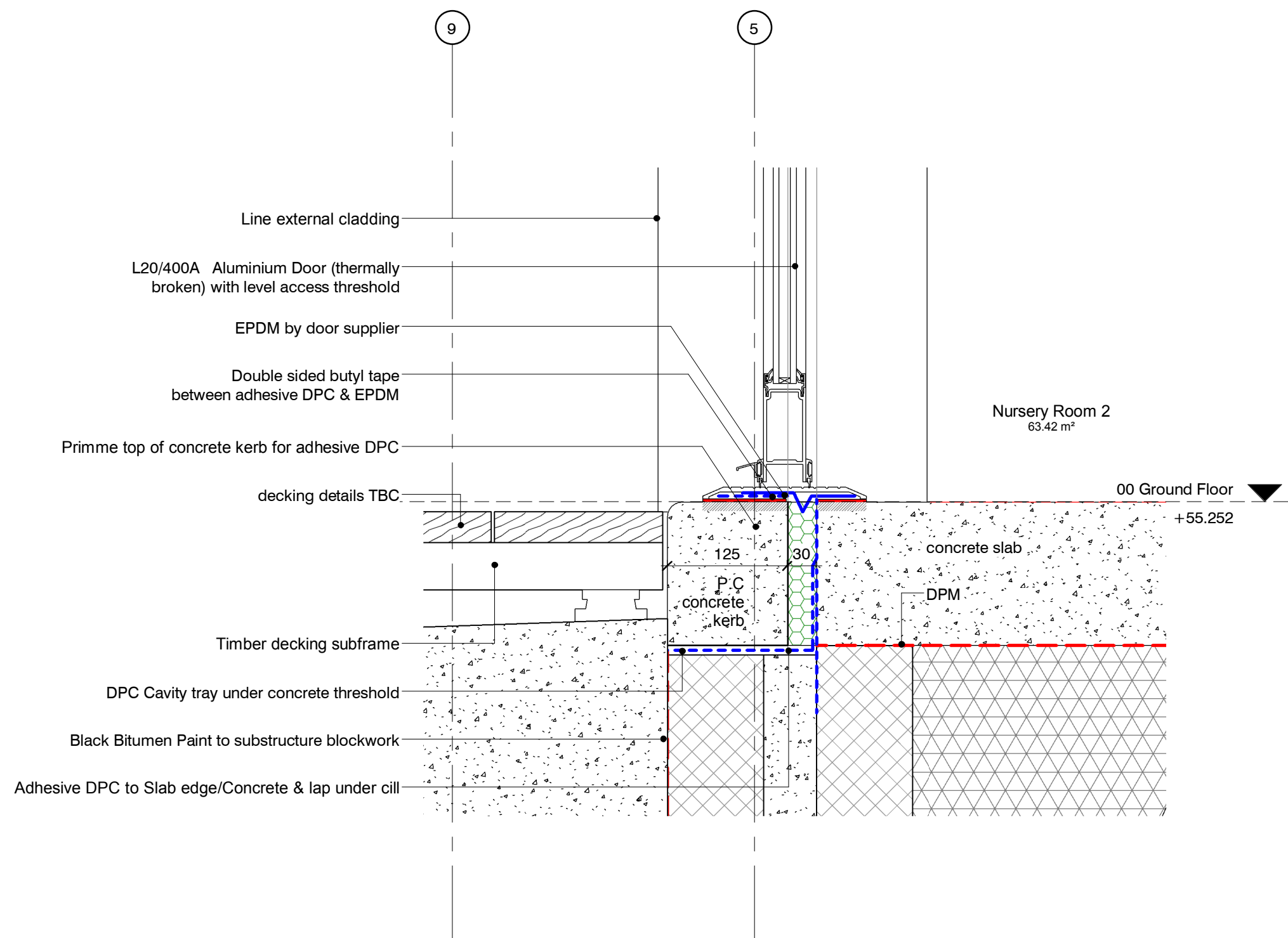

1 Existing Door Threshold/ Timber Decking  
1 : 5

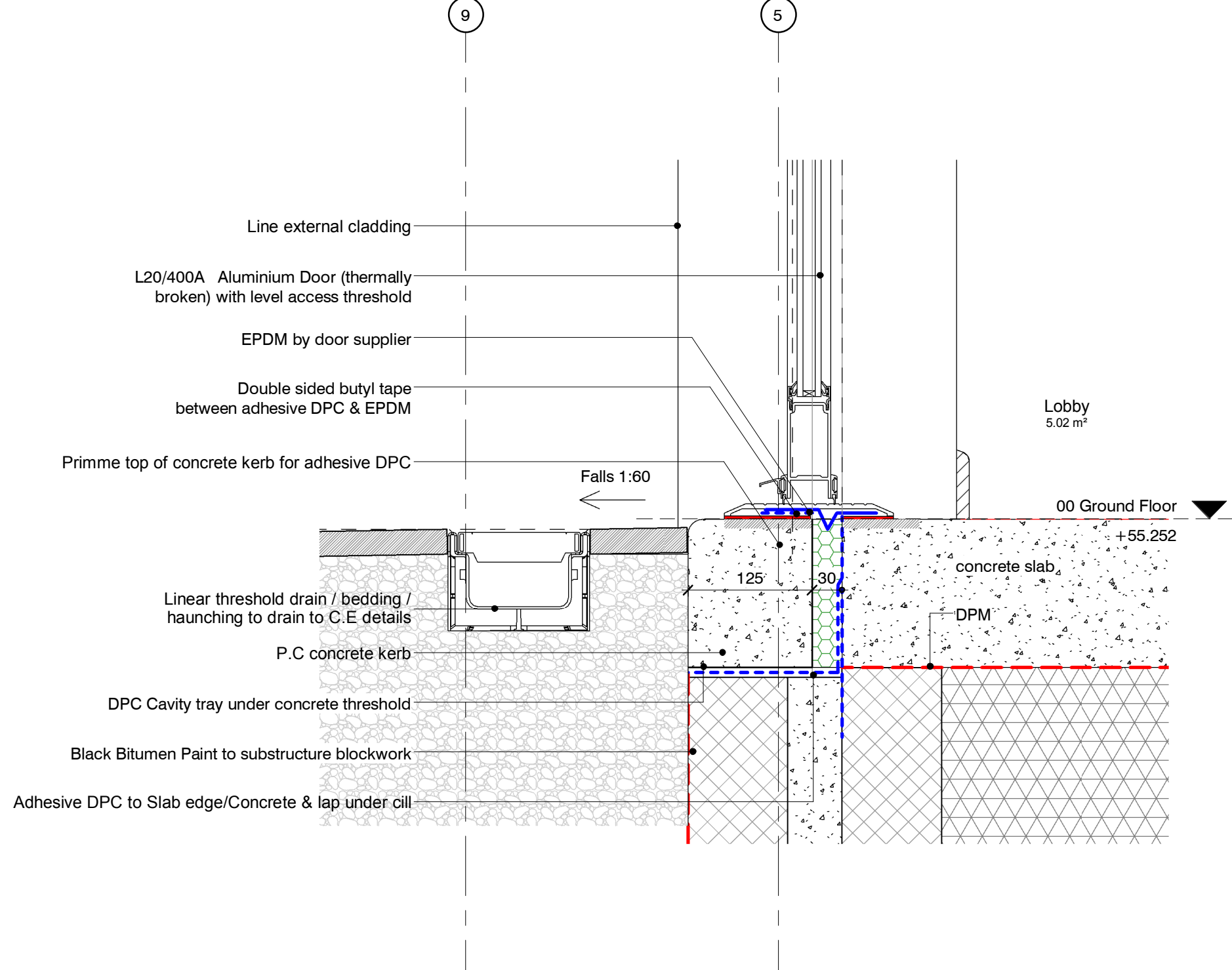

2 Main Entrance Level Threshold  
1 : 5

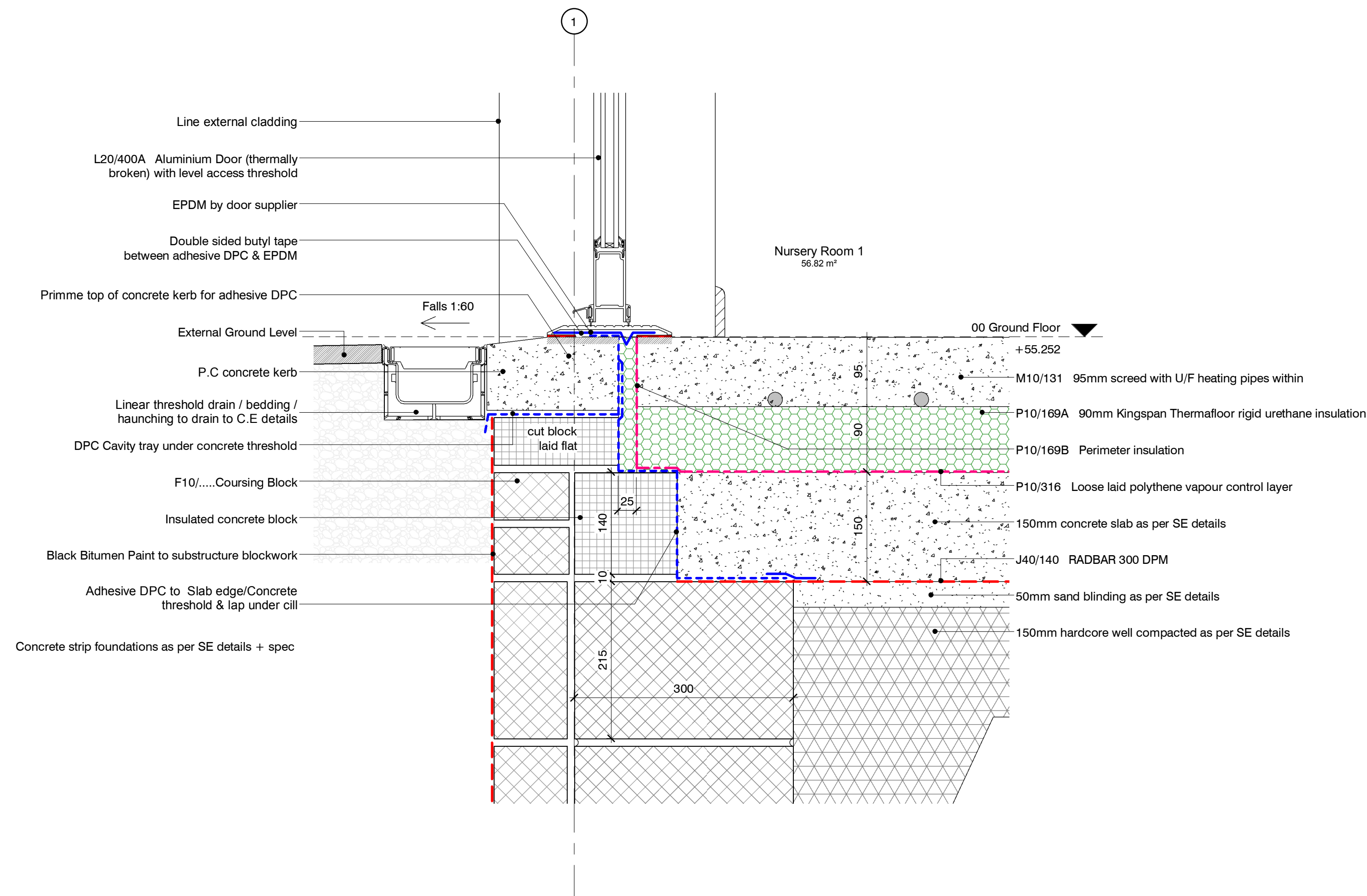

3 Level threshold/Floor slab junction  
1 : 5

D2	P26	15.11.2017	REISSUE FOR TENDER
D2	P24	13.11.2017	BUILDING CONTROL ISSUE
D2	P20	09.11.2017	TENDER ISSUE

STATUS	REV	DATE	DESCRIPTION	REVISED BY
CLIENT				KS
Council of the Isles of Scilly				CHECKED BY
				GF
				ORIGINATOR NO
				150457

CONSULTANT

**STRIDE TREGLOWN**

www.stridetreglow.com © Stride Treglow Limited 2016

PROJECT

Carn Gwavel  
Church Road  
St Mary's  
Isles of Scilly  
TR21 0NA

DRAWING TITLE

Details - Extension - Sheet 4

SUITABILITY STATUS	SCALE
D2 : SUITABLE FOR TENDER	1 : 5 @ A1
PROJECT   ORIGINATOR   ZONE   LEVEL   TYPE   ROLE   CLASSIFICATION   NUMBER	REVISION
150457-STL-XX-ZZ-DR-A-XXXX-42004	P26